

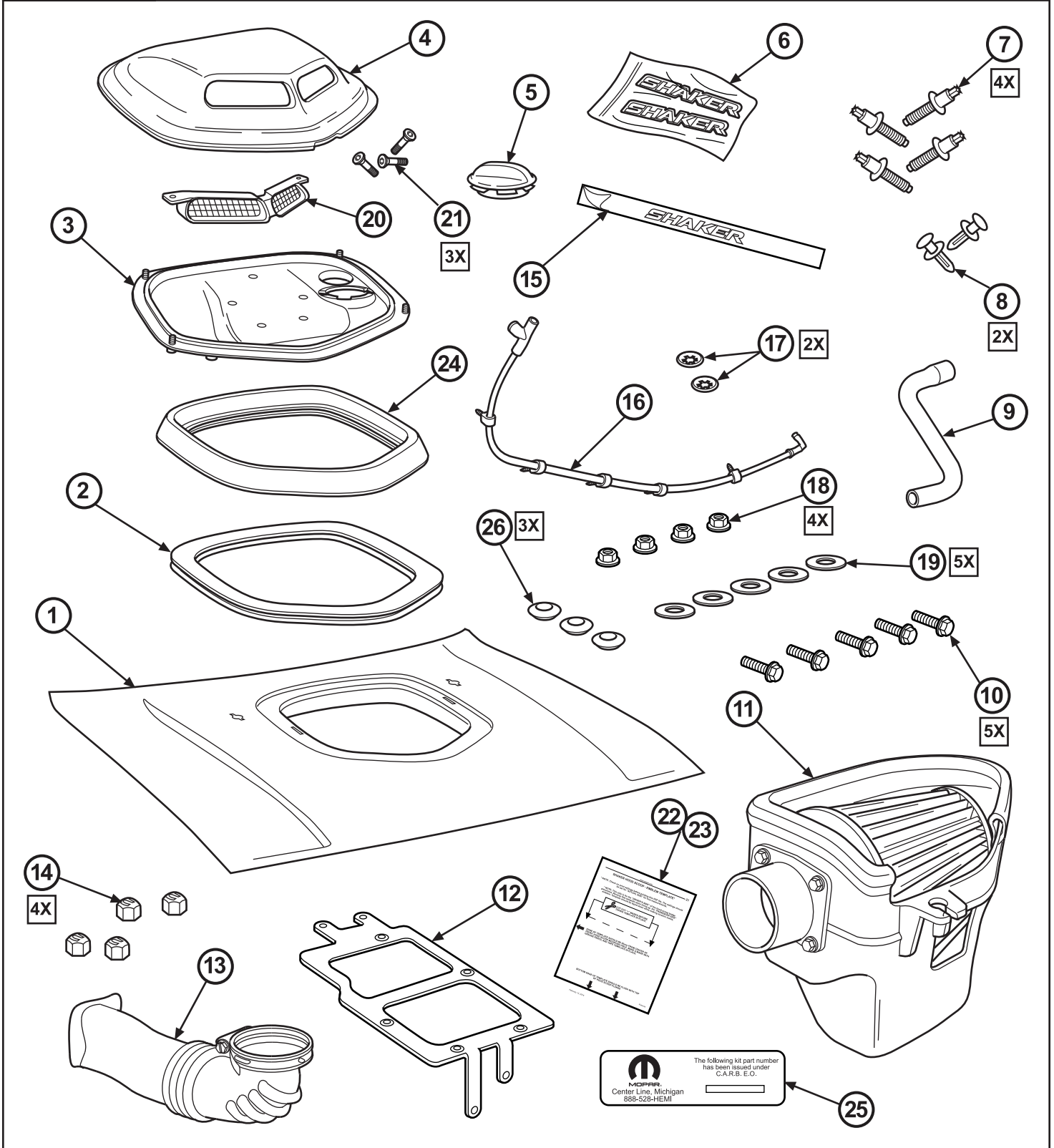

# SHAKER HOOD SCOOP KIT

## DODGE CHALLENGER 5.7 HEMI



## PARTS LIST

Callout	Description	Parts	Quantity
1	Dodge Challenger "Shaker" Hood	Supplied in kit	1
2	Hood Trim Ring (Unpainted - Adhesive Tape Pre-Applied)	Supplied in kit	1
3	Base Plate Assembly	Supplied in kit	1
4	Scoop Assembly (Primed ready for paint)	Supplied in kit	1
5	MOPAR Oil Fill Access Cap	Supplied in kit	1
6	"Shaker" Badges	Supplied in kit	2
7	Bracket Mounting Studs - M6 x 1.0 - External torx	Supplied in kit	4
8	Push Pins, Duct to Airbox	Supplied in kit	2
9	Air Hose "Make up"	Supplied in kit	1
10	Baseplate to Bracket Screws - M6 x 1.0 x 25	Supplied in kit	5
11	Airbox Kit Assembly w/Filter	Supplied in kit	1
12	Base Plate Bracket	Supplied in kit	1
13	Flexible Elbow Duct	Supplied in kit	1
14	Stainless Steel Cap Nuts - M6 x 1.0	Supplied in kit	4
15	"Shaker" Under Hood Decal	Supplied in kit	1
16	Washer Hose Kit (Usable section of hose)	Supplied in kit	1
17	Push Nuts	Supplied in kit	2
18	Bracket to Intake Manifold Nuts - M6 x 1.0	Supplied in kit	4
19	Compression Washers	Supplied in kit	5
20	Hood Scoop Bezel Grill	Supplied in kit	1
21	Scoop Bezel Screws - M4 x.7	Supplied in kit	3
22	Template, hood scoop badges-Drivers Side	Supplied in kit	1
23	Template, hood scoop badges-Passengers Side	Supplied in kit	1
24	Seal	Supplied in kit	1
25	E.O. Label	Supplied in kit	1
26	M4 Conical Spring Washers	Supplied in kit	3

## TOOLS REQUIRED



Torque Wrench

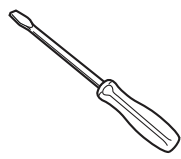

Flathead Screwdriver

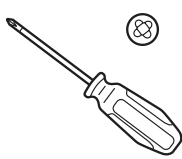

Phillips Head Screwdriver

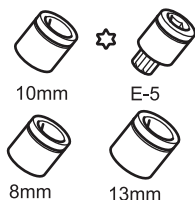

10mm

E-5

8mm

13mm

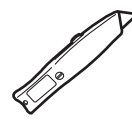

Knife



Trim Tool

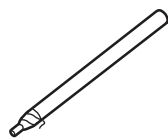

Grease Pencil



Scissors



Masking Tape



Alcohol



Socket Wrench



Shop Rags



10mm Wrench

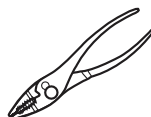

Pliers



Wire Cutters

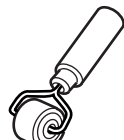

10LB Roller

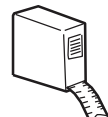
Adhesion Promoter  
(3M-94) Available in  
ampules pouch  
or loose at auto stores

Tape Measure



2.5 mm Hex

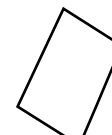

Squeegee

## PROCEDURAL STEPS

**NOTE:** For safety, ease of installation and to avoid damage to any parts, it is recommended to have an assistant aid in installing this kit.

1. Open trunk and pull back trunk floor cover, disconnect battery at the “-” NEGATIVE battery post only with a 10mm wrench.

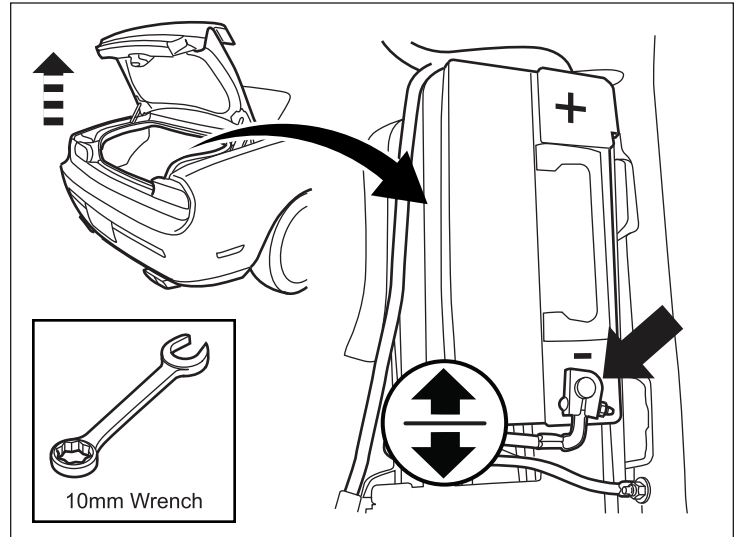

2. Open vehicle hood.

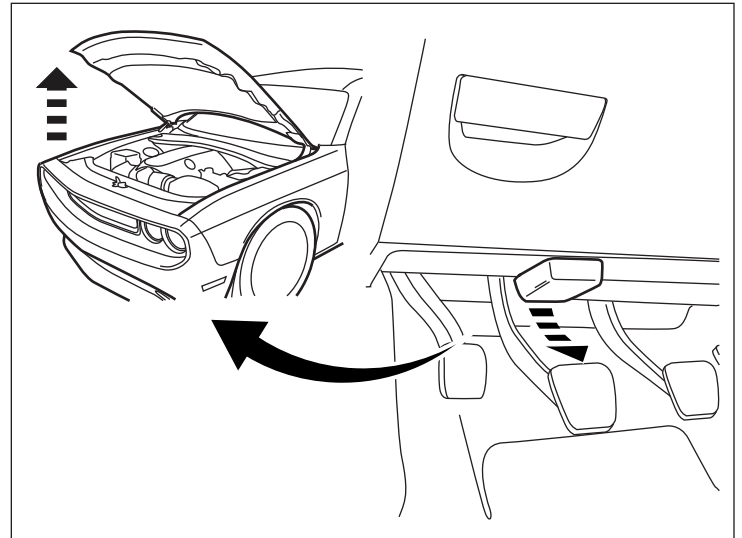

3. Remove all of the hood insulator pad locking clamps with pliers, wire cutters & trim tool.

Discard locking clamps.

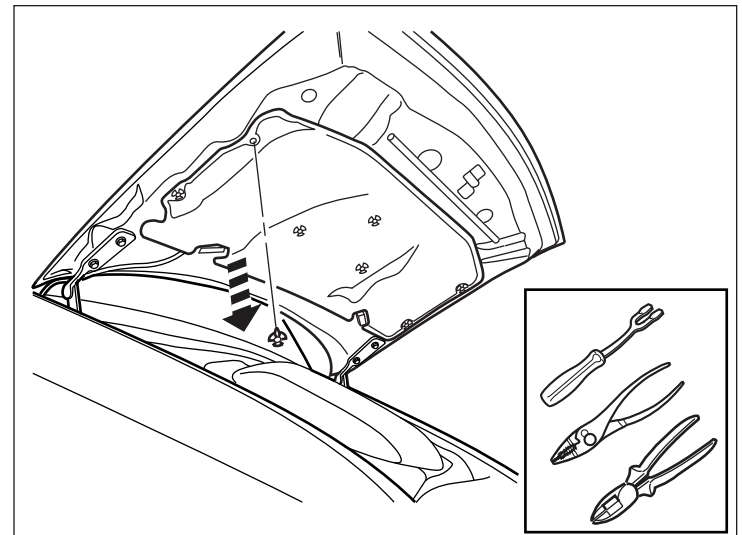

4. Remove hood insulator pad and disconnect the washer hose from each windshield-washer sprayer. Then remove each windshield-washer sprayer.

**NOTE: Save windshield wiper sprayers to be re-installed on the "Shaker" hood.**

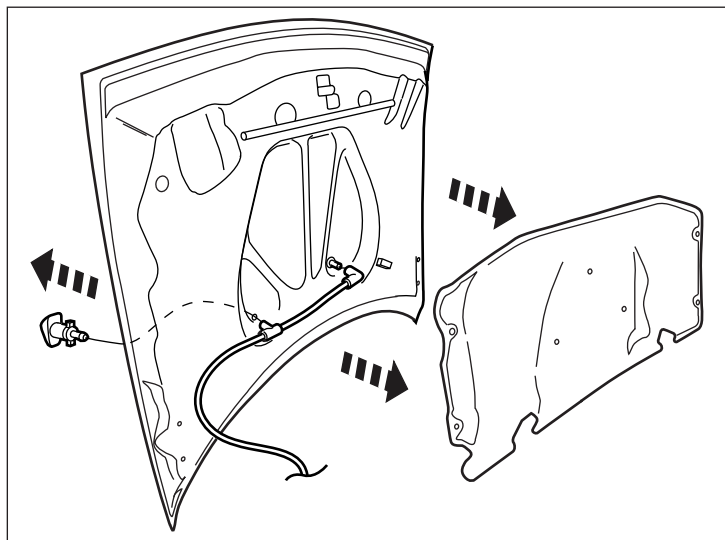

5. Disconnect windshield-washer hose from underneath hood. The section of washer hose between elbow and T-joint is not required for the Shaker hood.

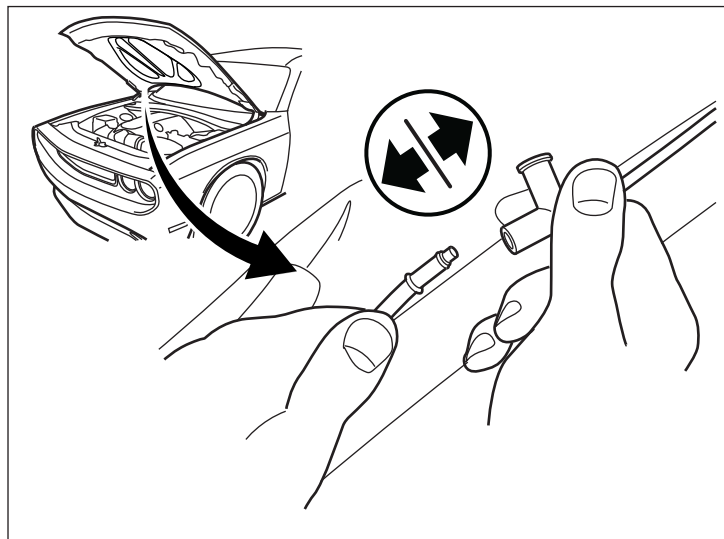

6. Pry hose clip from side of hood and mounting clip on the hood, holding down the washer hose.

**NOTE: Save clips and washer hose for reinstallation.**

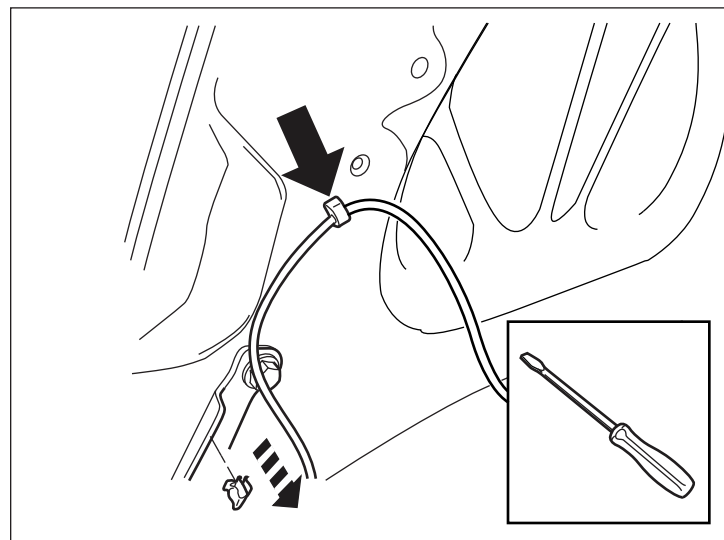

7. Block rear of hood with a suitable material so that hood does not slide or cause damage to vehicle upon removing hood bolts.

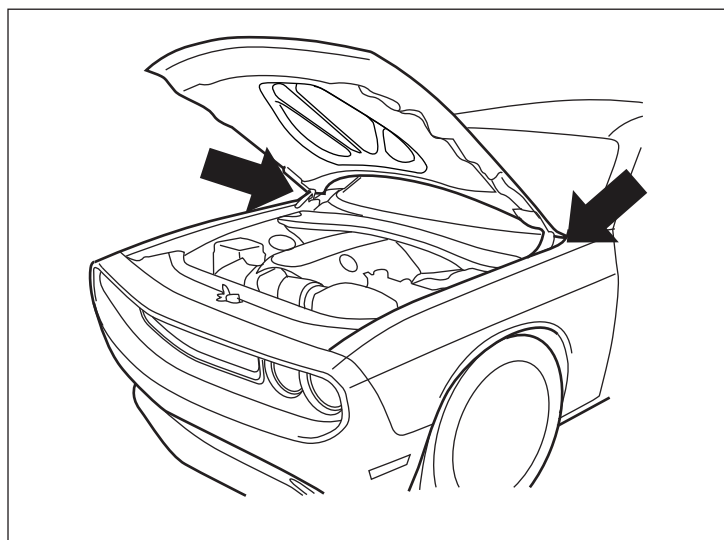

**CAUTION:** For safety, ensure there is at least one to two assistants holding the hood while removing the hood bolts.

8. Remove two passenger side hood bolts using a 13 mm socket.

**NOTE:** Save hood bolts for reinstallation.

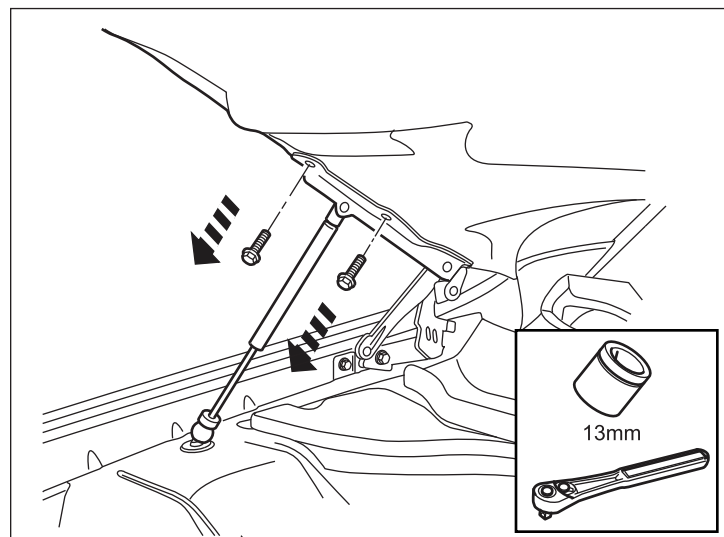

9. Remove two driver's side hood bolts using a 13 mm socket.

**NOTE:** Save hood bolts for reinstallation.

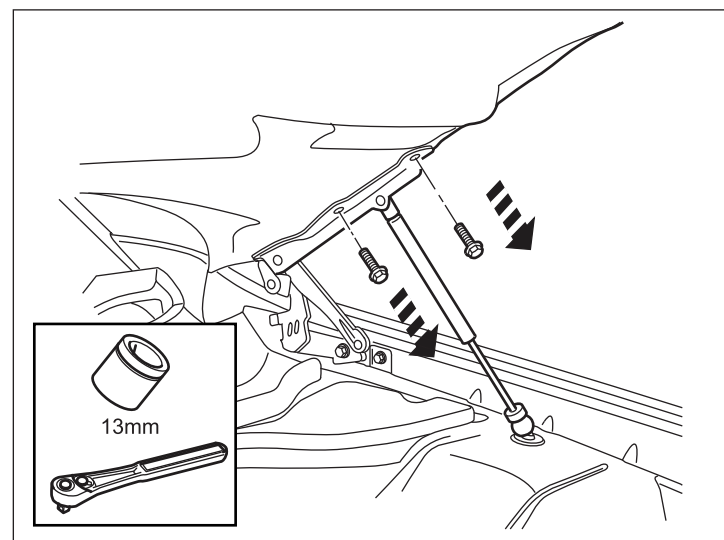

10. Lift and remove hood.

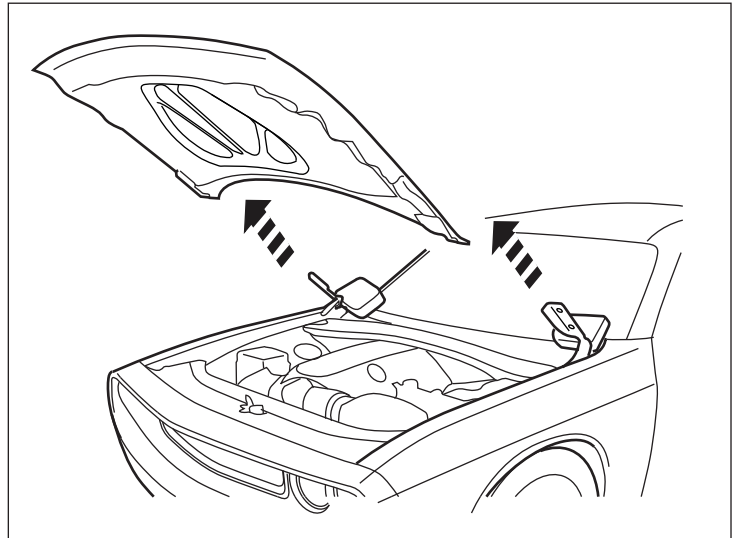

11. Remove the engine cover.

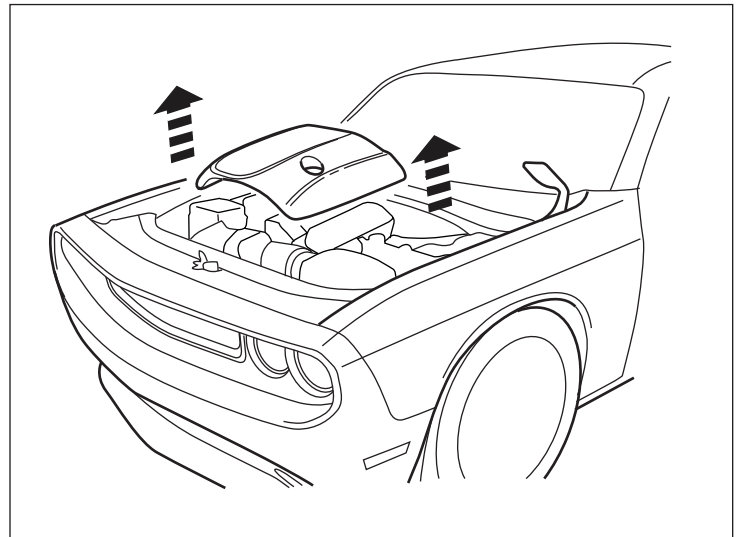

12. Remove small breather hose from airbox and engine.

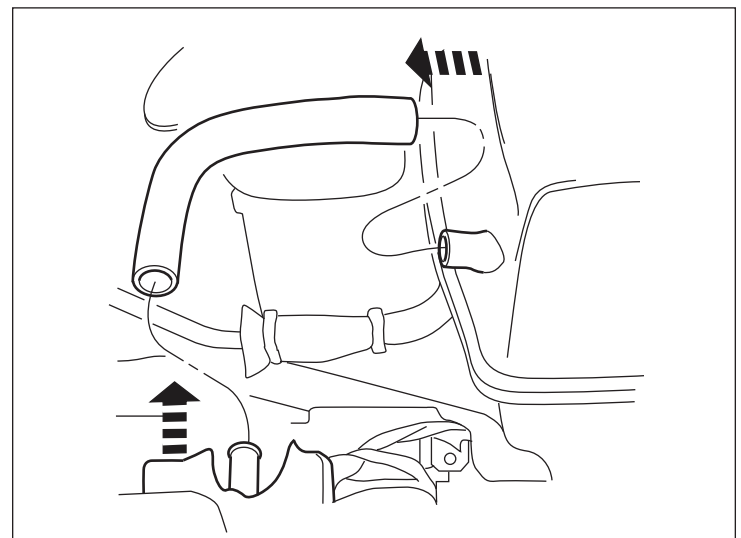

### 13. PRE-ASSEMBLED AIRBOX

**NOTE:** Refer to I-Sheet K6862089 for cold air intake removal & installation, in component bag.

Reinstall the grommet bushing to the airbox mount on the Mopar Shaker cold air intake - Per K6862089

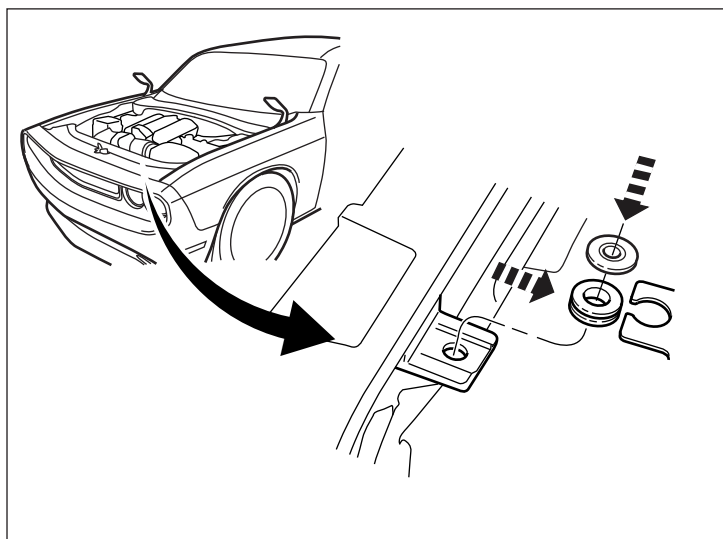

14. Install new Airbox (11) into engine compartment in the same location where the old airbox was mounted. Reinstall airbox mounting bolt with an 8mm socket torque to: 4 N.m. (35.4 in-lbs.)

**NOTE:** Ensure airbox is properly seated onto bottom of fender well. Failure to do so can result in a hood over flushness condition.

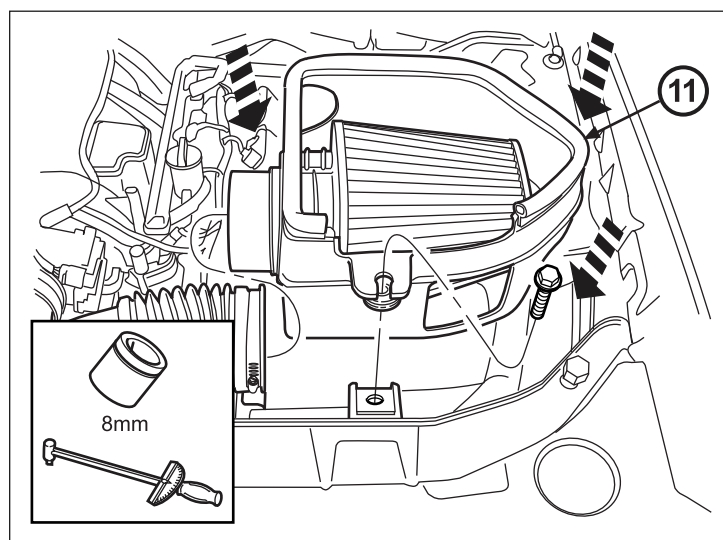

15. Slide airbox duct over airbox sleeve and secure clamp with a 8mm socket and torque to: 4 N.m. (35.4 in-lbs.)

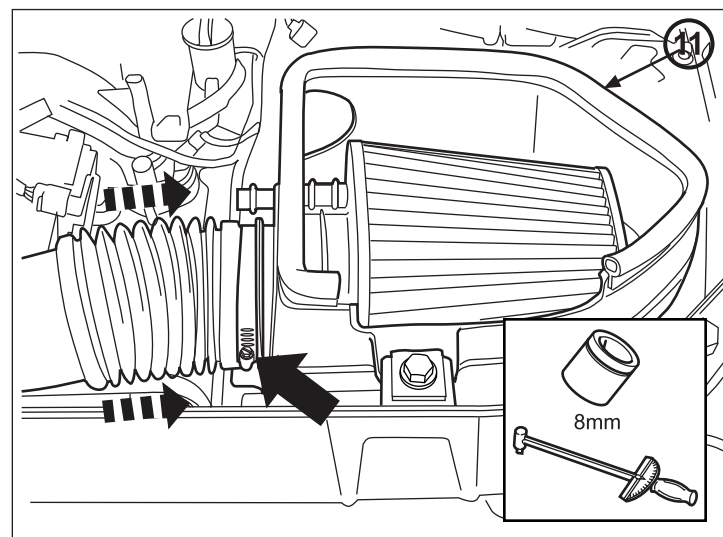



16. Connect “make up” small breather hose (9) to engine breather port and lower port on airbox (11). Ensure there is a snug fit on each end.

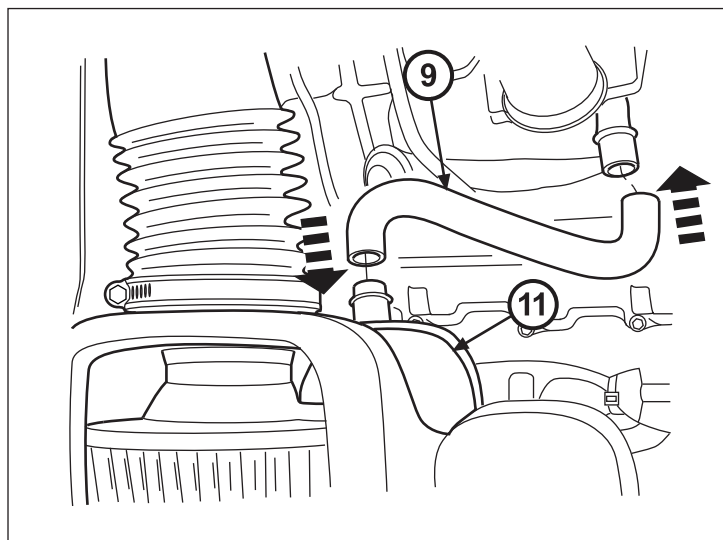

17. Attach front end of flexible elbow duct (13) to airbox opening (11). Align mounting holes in duct with holes in airbox. Use two push pins (8) and slide into each hole and push to lock in place.

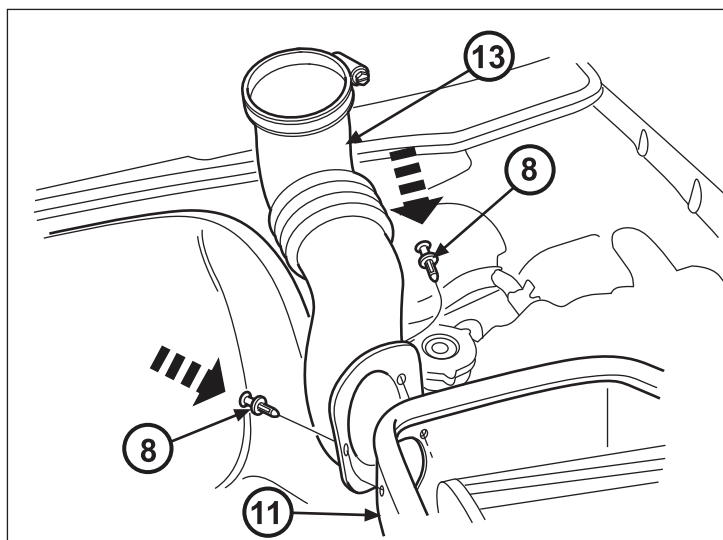

18. Install two self-tapping bracket mounting studs (7) to the rear of the intake manifold bosses using a T-5 torx socket. Torque to 3N.m. (26.5 in-lbs.)

**Caution, do not over torque mounting studs as they may become stripped and result in permanent thread damage to the intake manifold.**

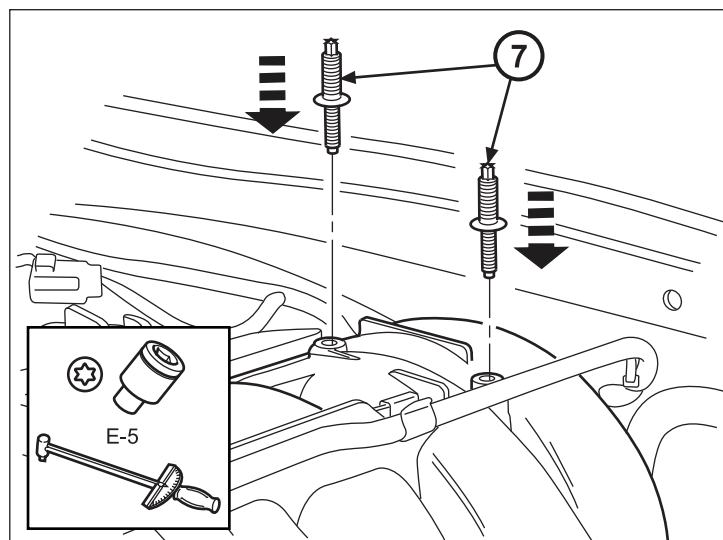



19. Install two self-tapping bracket mounting studs (7) to the front of the intake manifold bosses using a E-5 torx socket. Torque to 3 N.m. (26.5 in-lbs.)

**Caution, do not over torque mounting studs as they may become stripped and result in permanent thread damage to the intake manifold.**

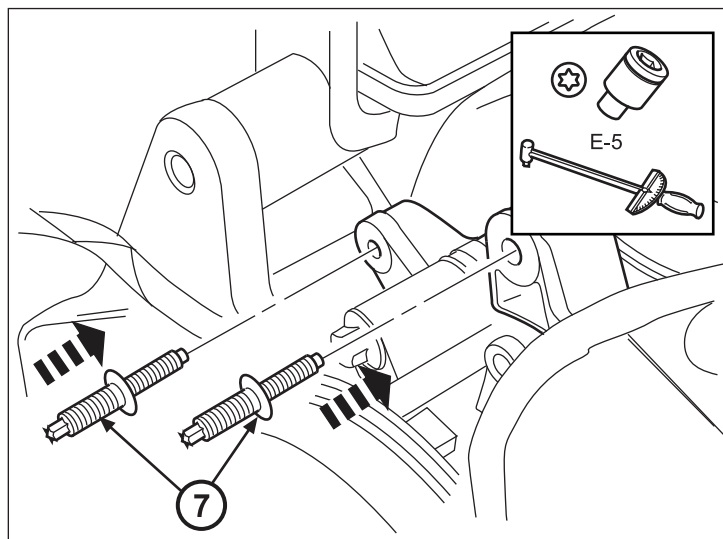

20. Line up base plate bracket (12) with front studs (7). Side bracket onto front studs then onto back studs (7).

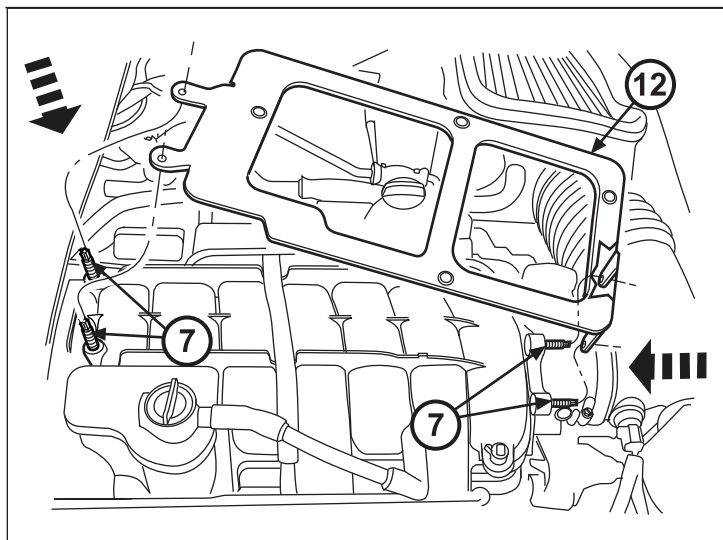

21. Install four M6 nuts (18) with a 10mm socket to mounting bracket studs (7).

Torque nuts (18) to 9 N.m each in a criss-cross pattern.

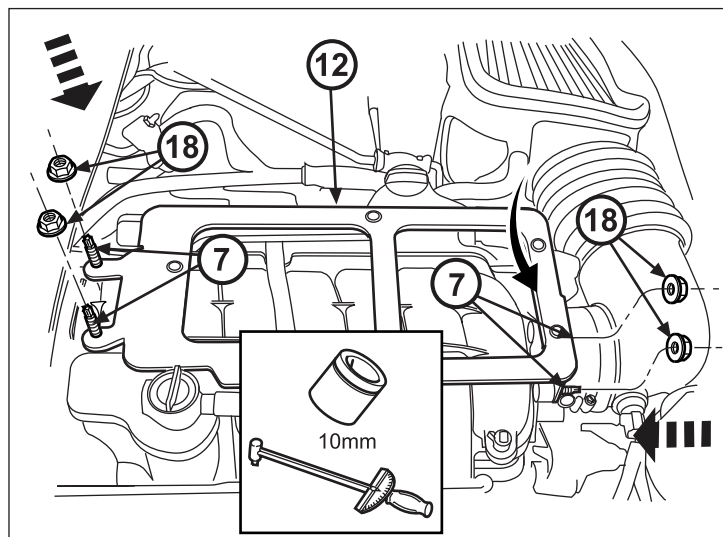

22. Place base plate assembly (3) on mounting bracket (12) and assemble five M6 screws (10) and five washers (19), finger tight securing base to bracket.

**NOTE:** Screws are to be left finger tight for proper adjustment of hood scoop base. There should be enough “drag” to keep baseplate from moving easily. Not too much that it can not be moved.

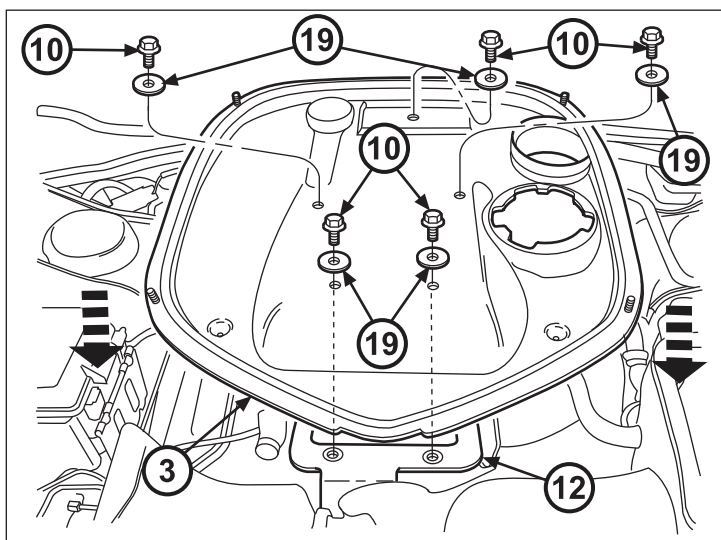

23. Install Mopar oil fill access cap (5) to base plate assembly (3). Ensure the the Mopar logo “M” faces inward towards the center of the engine as shown.

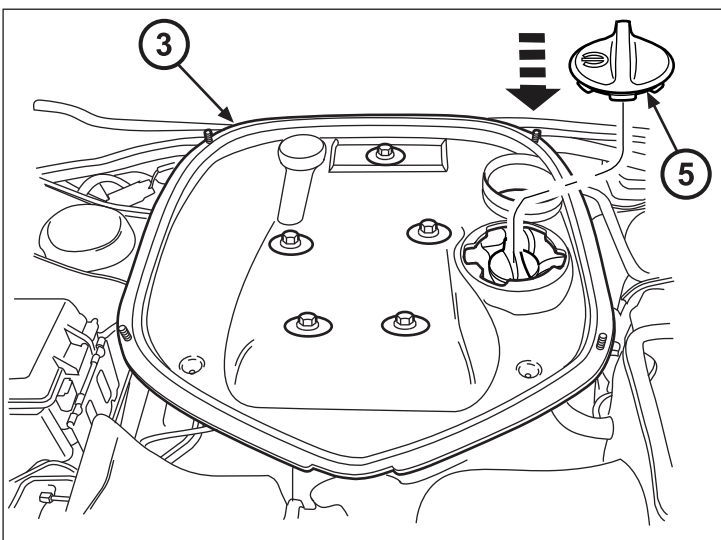

**NOTE:** For safety, ease of installation and to avoid damage to any parts, it is recommended to have an assistant aid in installing the hood.

23. Lift the “Shaker” Hood (1) and set on hood hinges. Ensure that hood is blocked from behind to avoid shifting or damaging the vehicle.

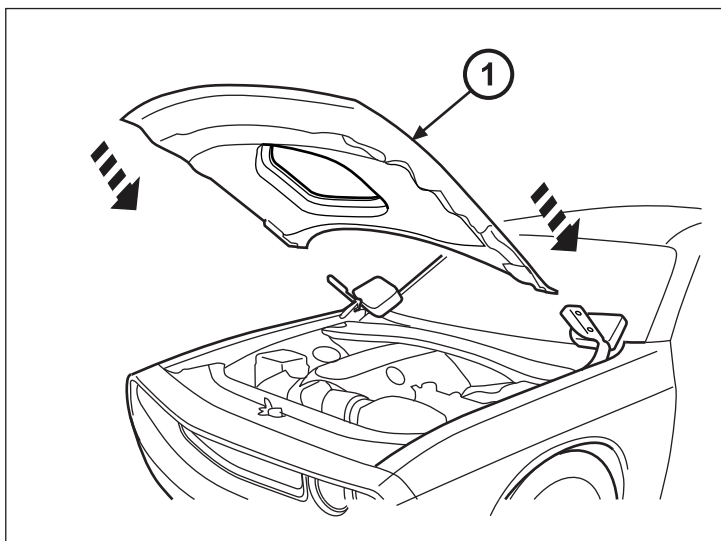

**CAUTION:** For safety, ensure there is at least one to two assistants holding the hood while removing the hood bolts.

24. Install two driver's side hood bolts to Shaker hood (1) using a 13 mm socket.

**Do not torque prior to final hood adjustment.**

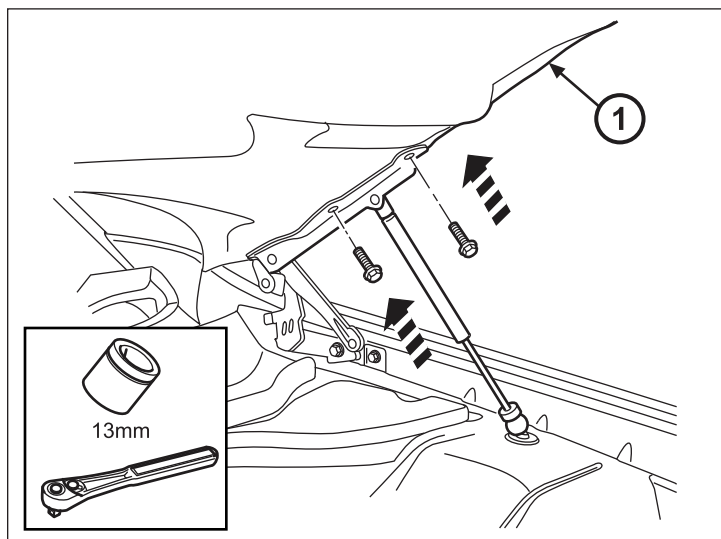

25. Install two passenger side hood bolts to Shaker hood (1) using a 13 mm socket.

**Do not torque prior to final hood adjustment.**

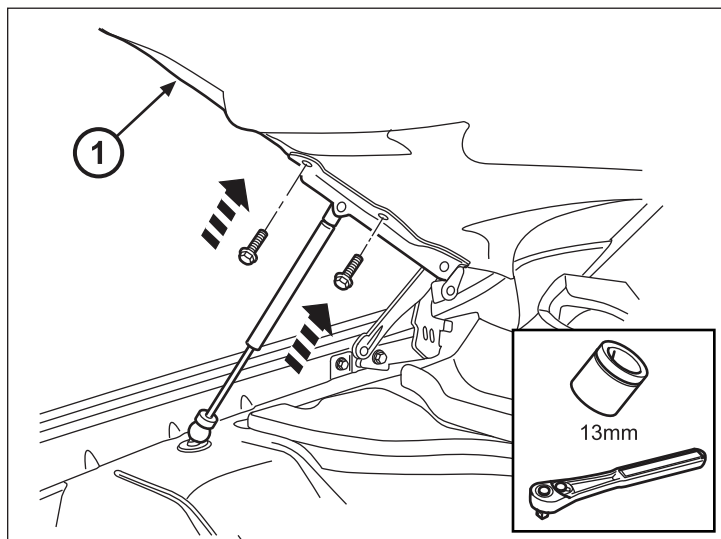

26. Gently lower the hood (1) down but do not shut the hood. Check alignment on all sides of hood to ensure hood is aligned properly with fenders and front end.

Center hood for best fit, if necessary adjust hood height.

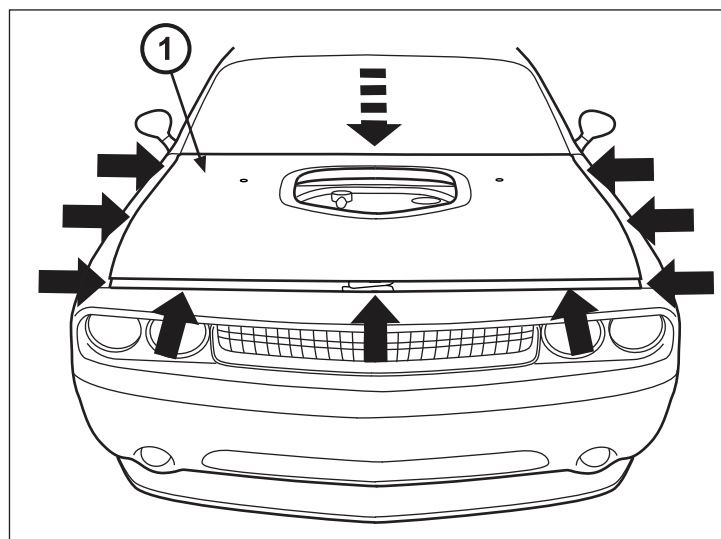

27. Once hood alignment is confirmed, reopen hood and torque hood bolts to 28 N.m (20 ft-lbs.) each with a 13mm socket.

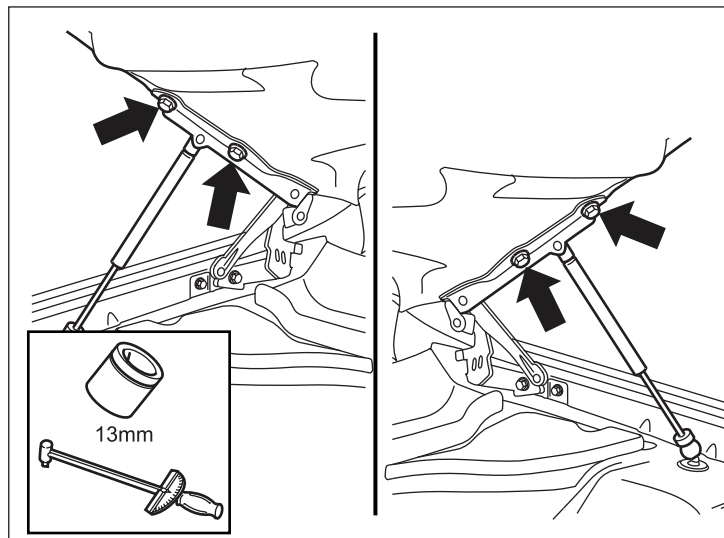

#### PAINTING OF HOOD SCOOP

28. **Sand** surface of hood scoop (4) with recommended 600 grit sandpaper. If small imperfections break through, fill with OEM approved filler.

**Prime** hood scoop (1) with PPG primer DP500.

**Paint** hood scoop (1) with PPG, RXF black with 15% gloss level production color.

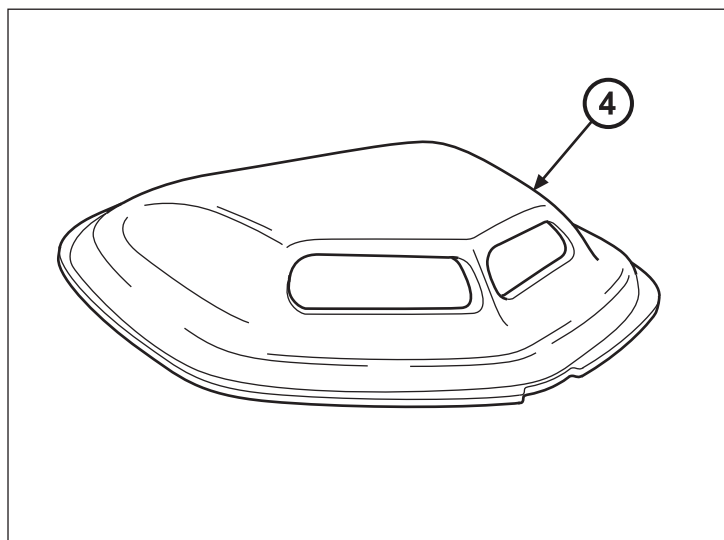

#### PAINTING OF TRIM RING

29. **Mask** off underside of trim ring (2) with masking tape covering mounting tapes, securely so that primer & paint do not contaminate trim ring mounting tape.

**Sand** surface of trim ring (2) with recommended 600 grit sandpaper. If small imperfections break through, fill with OEM approved filler.

**Prime** trim ring (2) with PPG primer DP500.

**Paint** trim ring (2) with production paint vehicle body color (color of trim ring is customer defined or PPG, RXF black with 15% gloss level production color).

**NOTE:** Prime & paint only "A" surface of trim ring (2). Do not paint underside of trim ring.

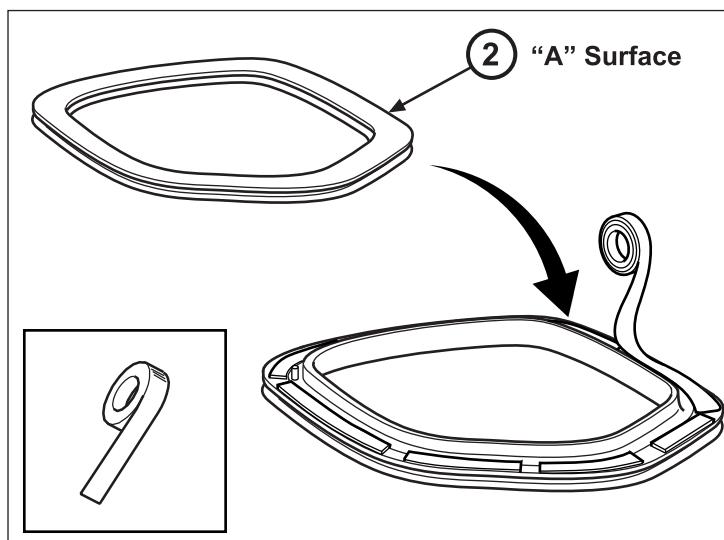

30. After paint has dried remove all masking tape on underside of trim ring (2) and discard.

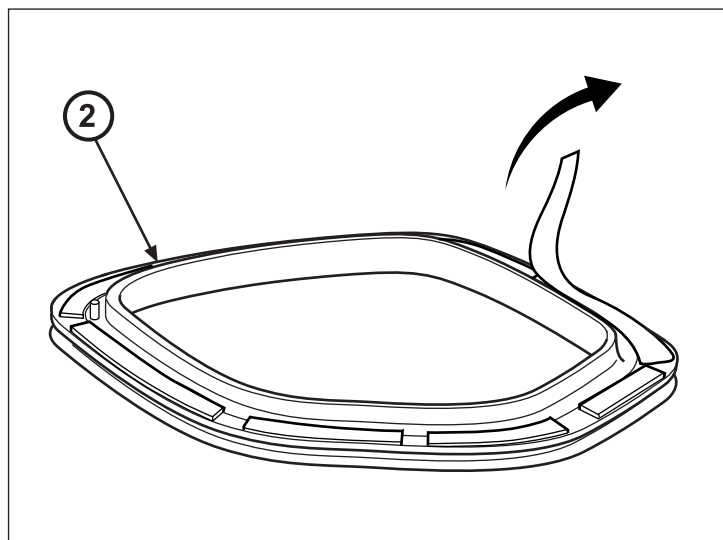

31. Clean outside surface of hood (1) area with alcohol and clean rags.

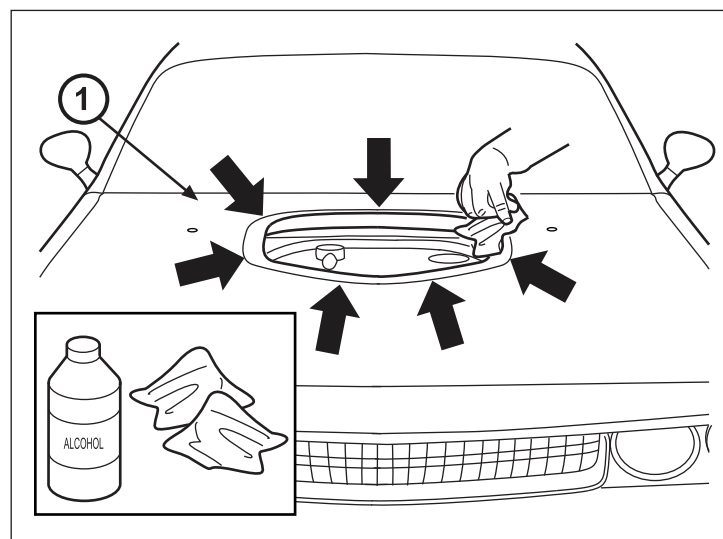

32. Pierce circle on side of tube of the adhesion promoter with knife to activate sealer. Or use loose 3M primer adhesion promoter.

**NOTE: Adhesion promoter is not included in this kit.**

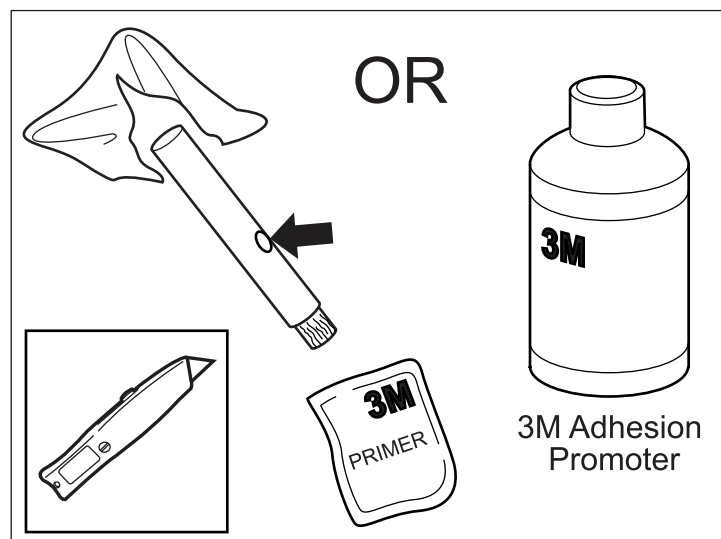

33. Apply adhesion promoter on the shaker hood indentation, where the trim ring (2) will seat and adhere onto the shaker hood (1).

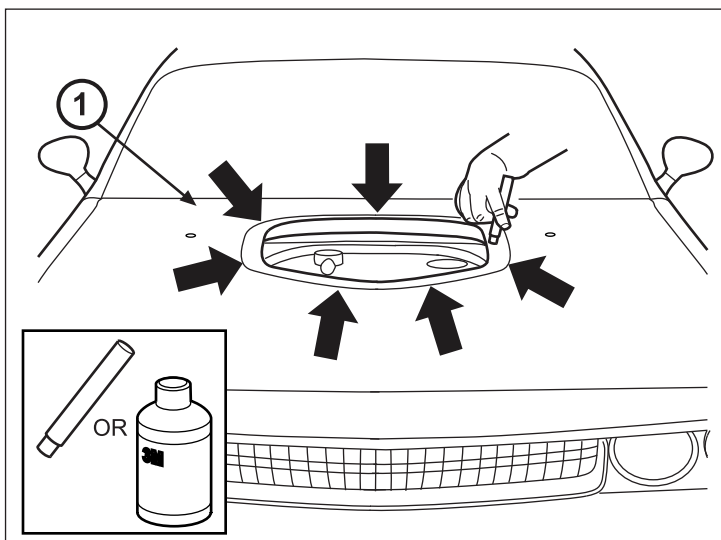

34. Remove the red liner from the tape on the trim ring (2). Align with hood and starting at the front of the hood opening and install working your way to the back.

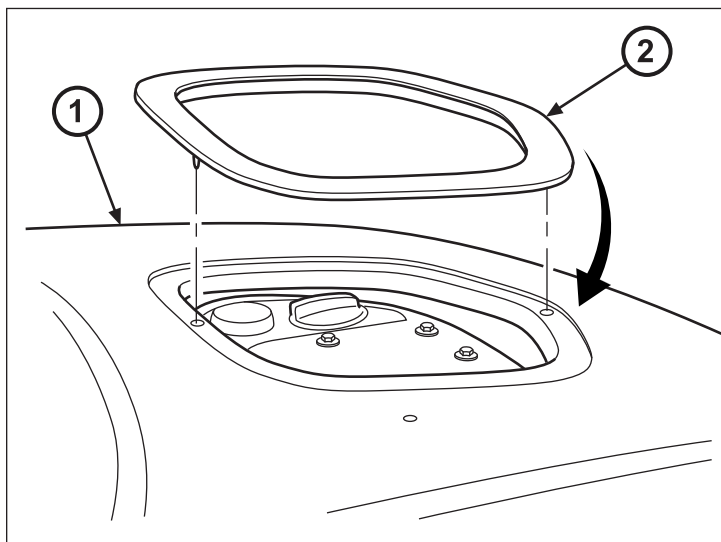

35. Ensure trim ring (2) is centered with hood and, around entire seal for a secure fit. Adjust trim ring where necessary for proper alignment and best fit.

Apply pressure with 10lb. roller or with thumb securing the trim ring.

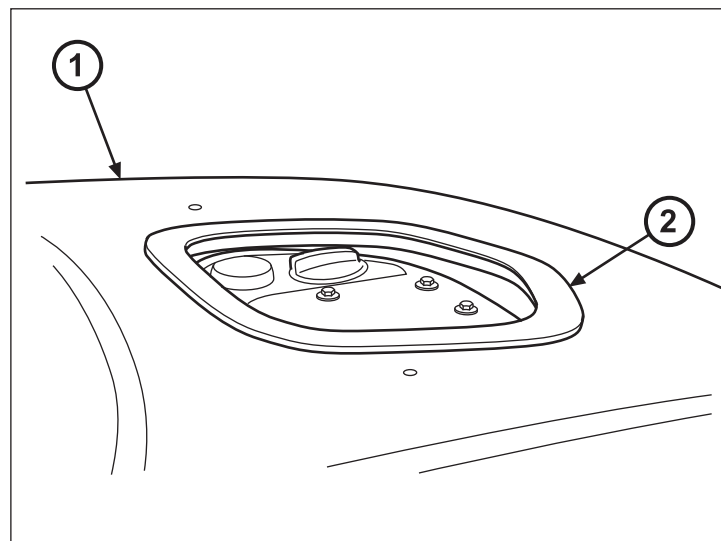

36. Open hood and snap in place two push nuts (17) on the two seal studs to secure trim ring in place.

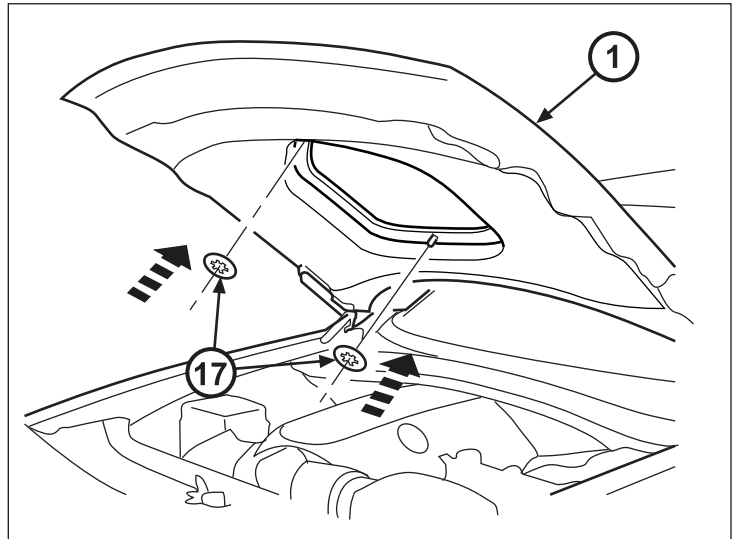

37. Clean hood surface inside of scoop opening to ensure a secure fit for the "Shaker" decal (15).

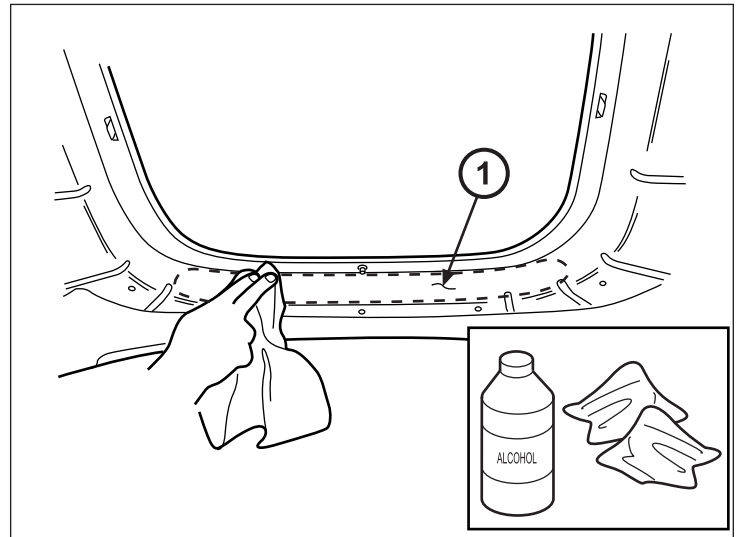

38. Peel off "Shaker" decal (15) backing and align decal in hood scoop opening locating lower corner notches with hood (1) indents as shown.

Use a squeegee across decal backing (15) to secure adhesion.

Press firmly and starting at one end and remove decal backing "slowly" to ensure adhesion. Wipe any bubbles out with clean dry towel.

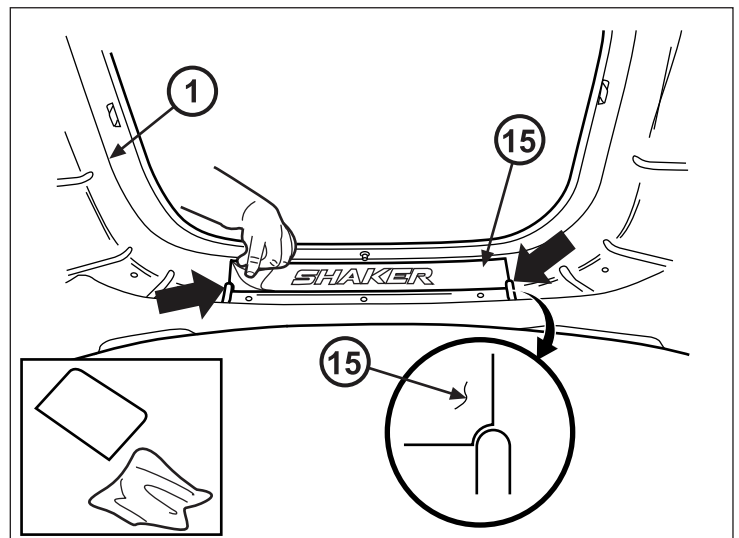



39. Reinstall washer sprayer nozzles to the hood (1). Ensure that the sprayer end faces the windshield.

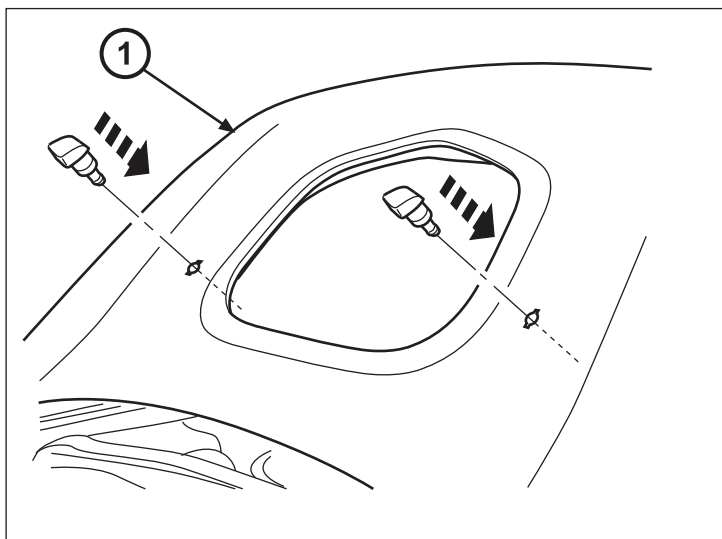

40. Install new washer hose jumper kit (16), snap mounting clips into shaker hood (1). Ensure that each rubber boot over each sprayer nozzle is securely mounted.

Discard the excess length of the hose, if provided with the hose kit (16). The usable section of hose from kit is the jumper between "T" & elbow joint.

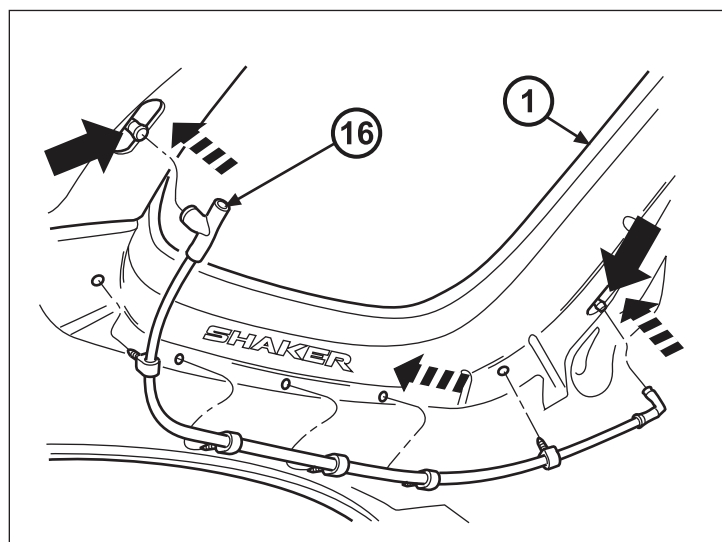

41. Reconnect the washer hose to the passenger side washer hose sprayer "T", and ensure fit is secure.

Reconnect mounting clip and side clip to hose onto hood (1) and secure routing of washer hose.

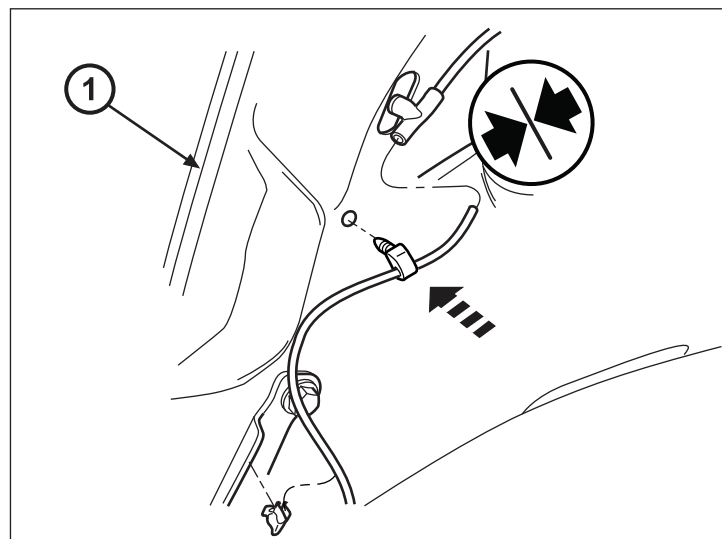

42. Install Hood scoop bezel grill (20) by placing front edge in first with three scoop bezel screws (21) and three conical spring washers (26). Using a 2.5mm hex wrench, torque screws to 1.5 N.m (8.8 in-lbs.)

**NOTE: Rock bezel in to ensure tabs are secured at top. Assemble center fastener first & then apply hand force to each outside edge of bezel to push flush against scoop before final torquing to 1.5 Nm"**

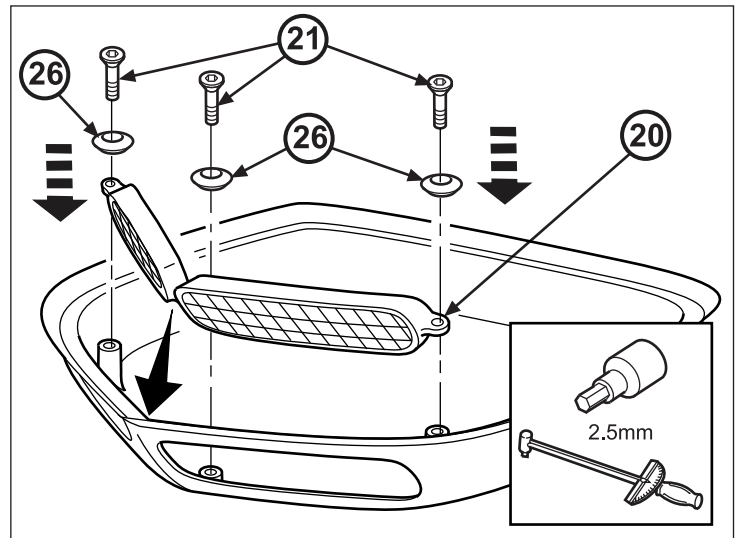

43. Place hood scoop (4) on a secure surface and clean both sides with alcohol and clean rags.

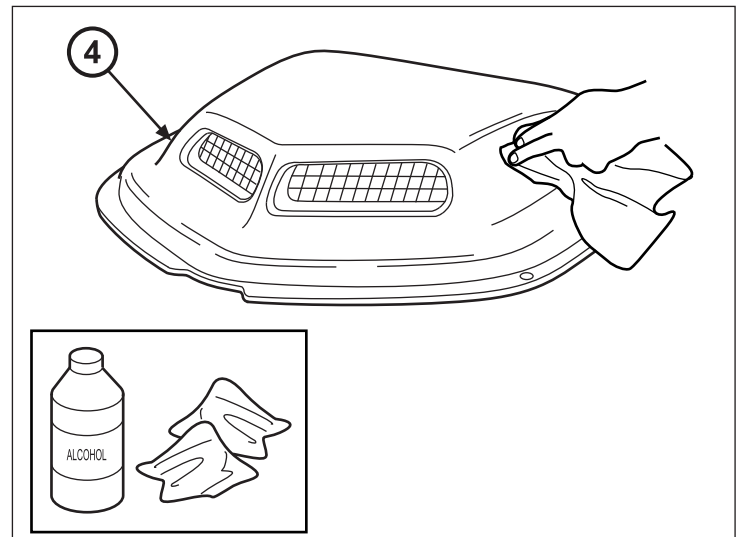

44. Cut across dotted line on the Shaker badge template, Driver's side, (22) discard cutout.

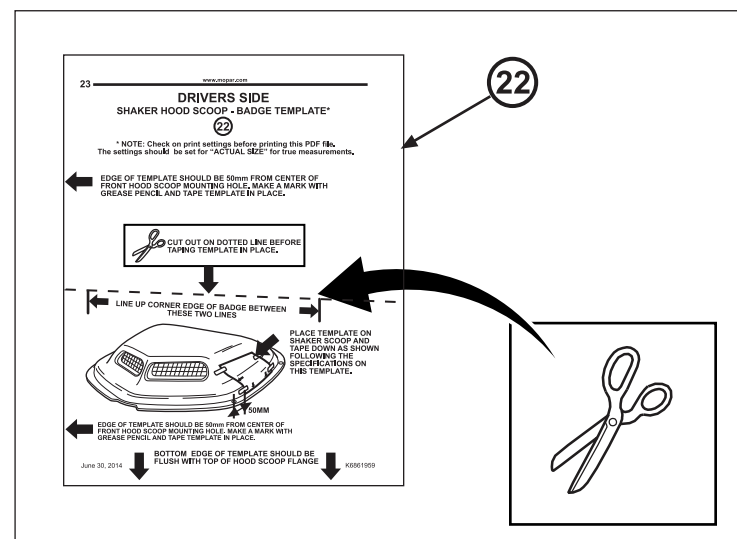

45. Measure 50mm from center of forward mounting hole. Scribe a mark on hood scoop (4) with a grease pencil.

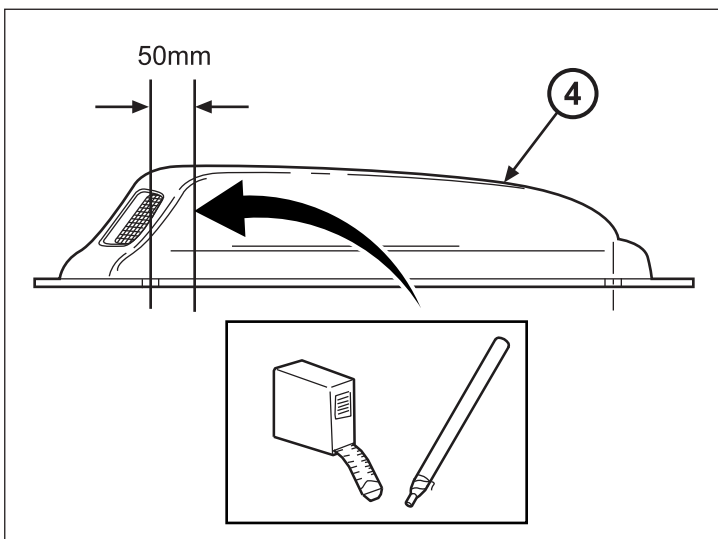

46. Line up template (22) to top of hood scoop (4) flange and 50mm mark as shown, tape template in place.

Repeat steps 44-46 for "Passenger's Side" of Shaker badge placement, using template (23).

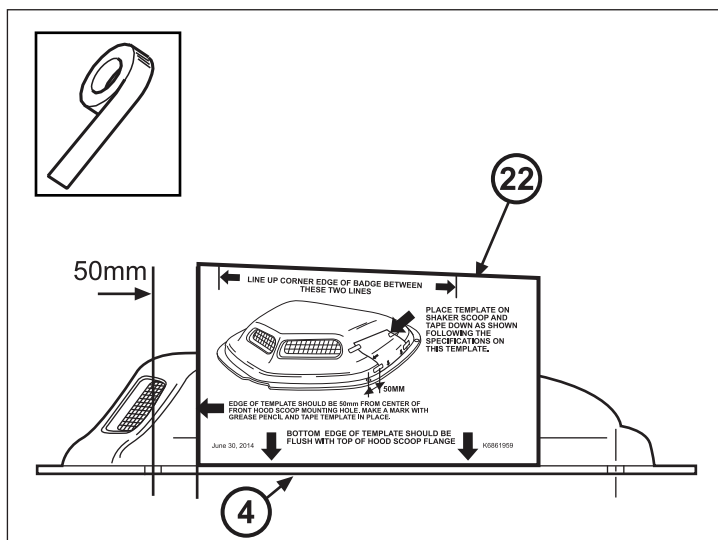

47. Peel back adhesive cover on each "Shaker" badge (6). Place badge (6), one on each side of hood scoop (4) between location marks.

Press firmly to seal in place.

Use alcohol to clean off location marks on hood scoop (4).

Install seal (24) to hood scoop (4) ensuring that the notches on the seal are aligned around each scoop mounting hole and water drain slot properly, adjust for best fit.

Repeat Step 47 or "Passenger's Side".

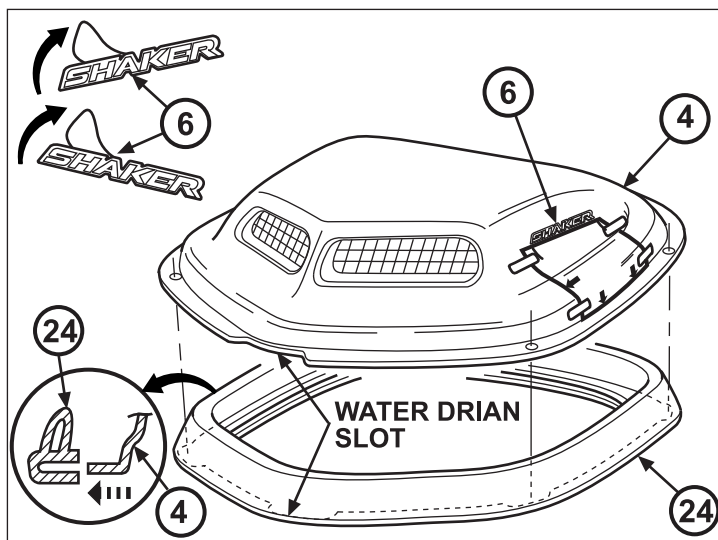

48. Install hood scoop (4) over base (3) studs snug tight.

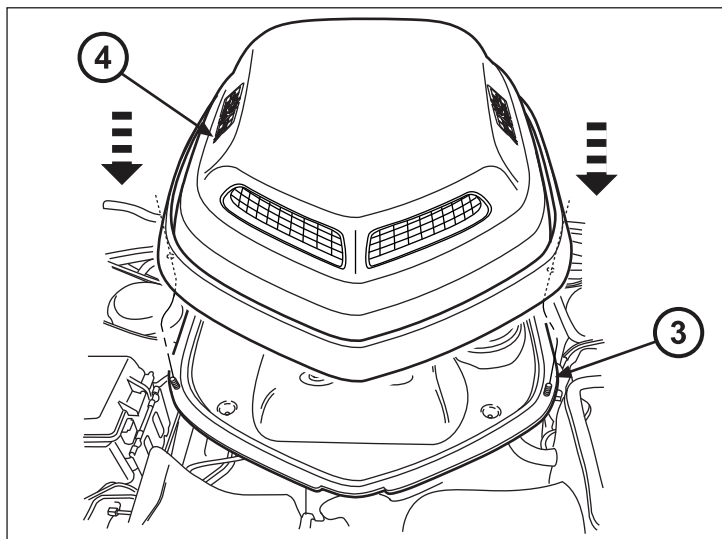

49. Close hood slowly and adjust hood scoop (4) with center of hood, adjust for best fit. If hood scoop is out of line, open hood and readjust hood scoop base. Repeat this procedure and check again.

**NOTE: Seal should fit slightly tighter at the front. Visually examine seal for alignment. Shaker can be adjusted  $\pm 6.0\text{mm}$ .**

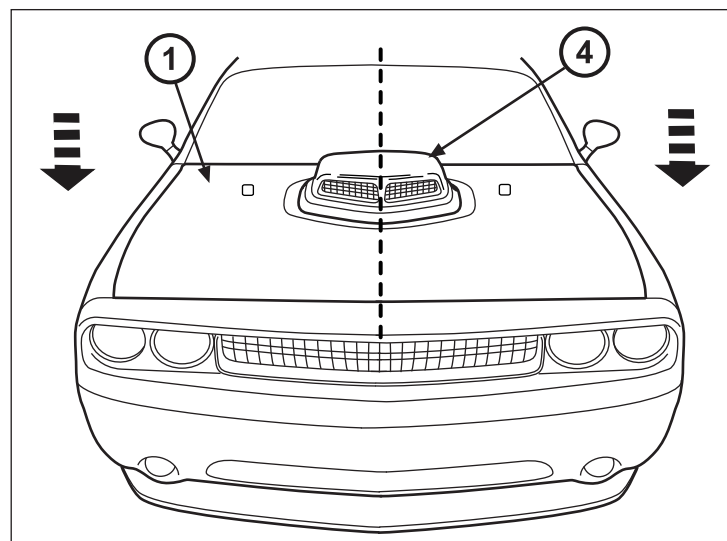

50. Once hood scoop (4) is aligned for best fit with hood closed, open hood and check distance between hood scoop and firewall weatherstripping. Ensure there is  $\sim 8.0\text{ mm}$  gap between the two.

If the distance is too tight, readjust hood scoop base and repeat this step.

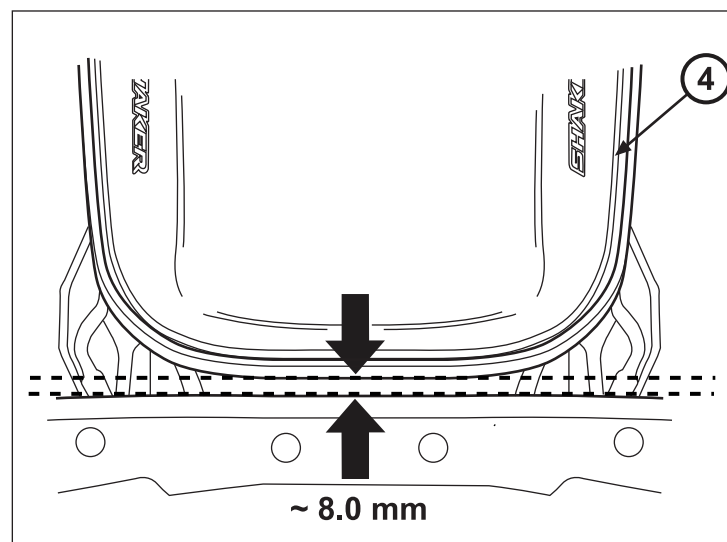

51. Open hood and gently remove the hood scoop, taking care not to move baseplate.

Using a 10mm socket, torque Base plate to bracket screws (10) to 5 N.m. (44 in-lbs.)

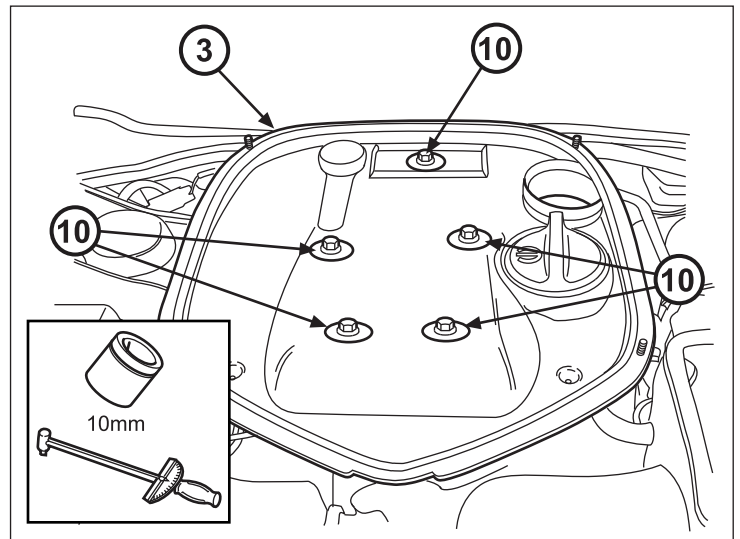

52. Reinstall hood scoop (4). Fasten four M6 stainless steel cap nuts (14) with a 10mm socket. Torque to 4 N.m. (35.4 in-lbs.)

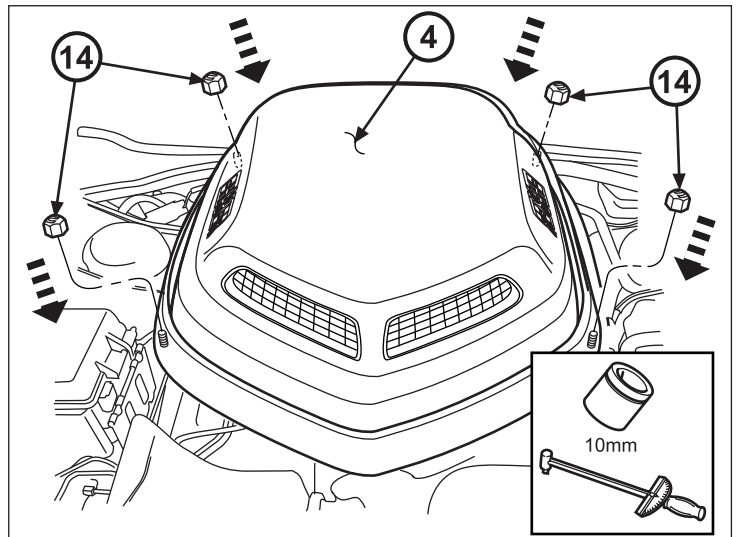

53. Install the flexible elbow duct (13) to the bottom of the hood scoop base (3).

**NOTE: There is a shoulder in the duct to control how far the duct needs to seat.**

Using an 8mm socket, tighten clamp to 4 N.m. (35.4 in-lbs.)

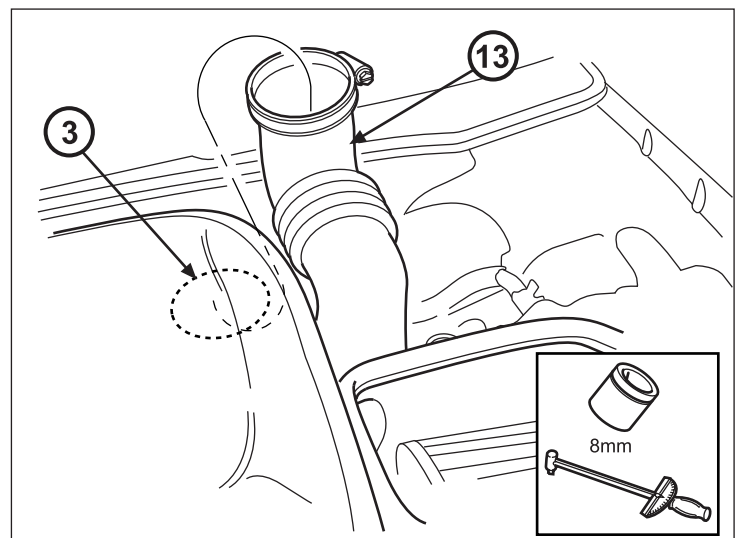

**NOTE: PRODUCT INFORMATION LABEL IS REQUIRED TO AID IN PASSING THE CALIFORNIA SMOG CHECK PROGRAM**

54. Locate area for EO label (25) on front cowl above radiator.

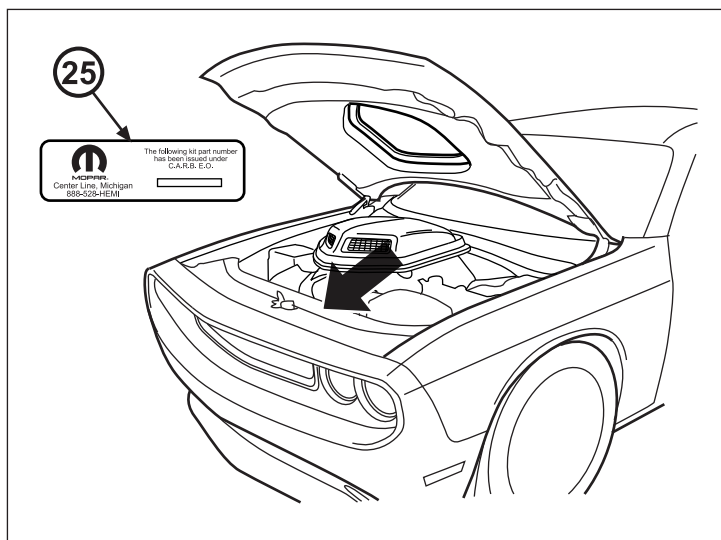

55. Peel backing off EO label (25), and place in desired location.

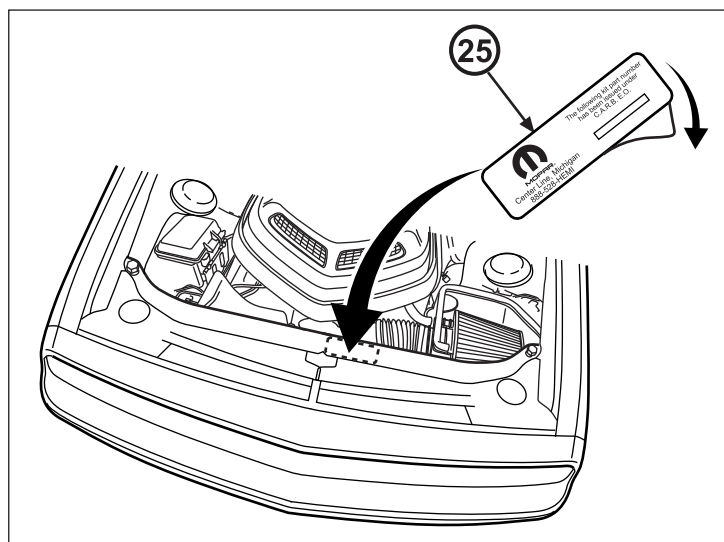

56. Ensure EO label (25) is visible to the average person when hood is opened.

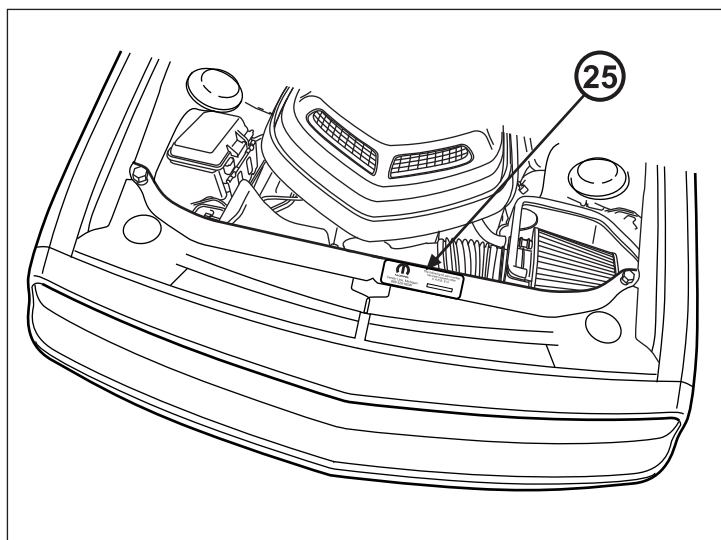

57. Open trunk lid and reconnect the battery with a 10 mm wrench.

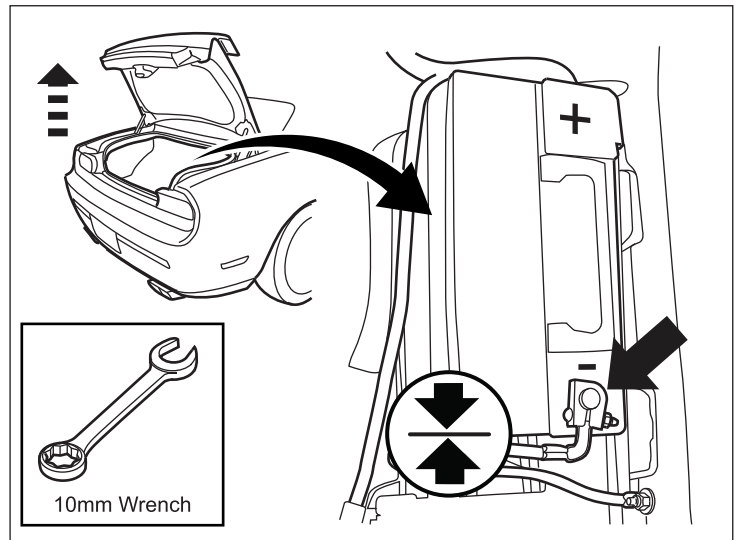

58. Test the washer sprayer with the hood opened recommend having a person observe under the hood for any leaks on the washer hose (16).

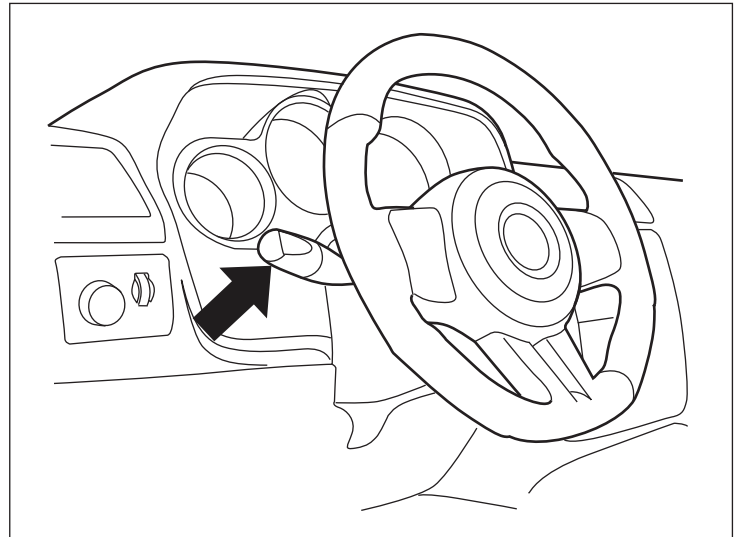

59. Inspect all washer hose (16) connections under the hood for any leaks. If any leaks are present double check all connections to ensure proper fit and test again.

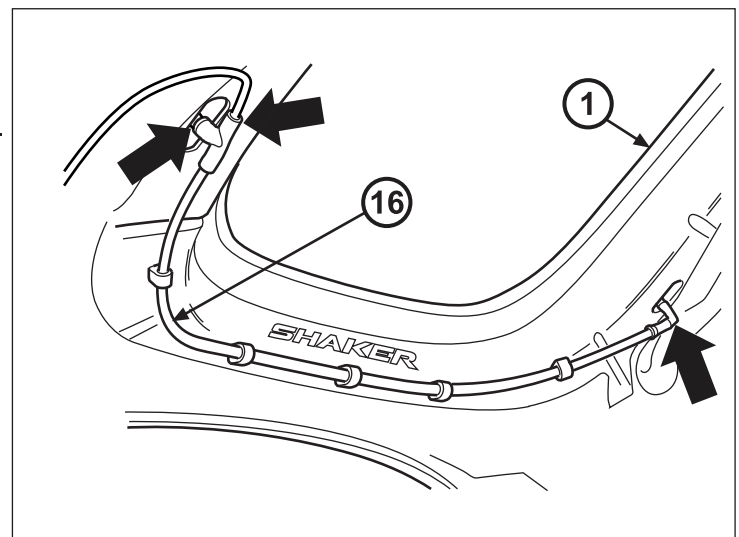



## DRIVERS SIDE SHAKER HOOD SCOOP - BADGE TEMPLATE\*

22

\* **NOTE:** Check on print settings before printing this PDF file.  
The settings should be set for "ACTUAL SIZE" for true measurements.



**CUT OUT ON DOTTED LINE BEFORE  
TAPING TEMPLATE IN PLACE.**

**LINE UP CORNER EDGE OF BADGE BETWEEN  
THESE TWO LINES**

**PLACE TEMPLATE ON  
SHAKER SCOOP AND  
TAPE DOWN AS SHOWN  
FOLLOWING THE  
SPECIFICATIONS ON  
THIS TEMPLATE.**

**50MM**

**EDGE OF TEMPLATE SHOULD BE 50mm FROM CENTER OF  
FRONT HOOD SCOOP MOUNTING HOLE. MAKE A MARK WITH  
GREASE PENCIL AND TAPE TEMPLATE IN PLACE.**

**BOTTOM EDGE OF TEMPLATE SHOULD BE  
FLUSH WITH TOP OF HOOD SCOOP FLANGE**

## PASSENGER'S SIDE SHAKER HOOD SCOOP - BADGE TEMPLATE\*

23

\* NOTE: Check on print settings before printing this PDF file.  
The settings should be set for "ACTUAL SIZE" for true measurements.



CUT OUT ON DOTTED LINE BEFORE  
TAPING TEMPLATE IN PLACE.



PLACE TEMPLATE ON  
SHAKER SCOOP AND  
TAPE DOWN AS SHOWN  
FOLLOWING THE  
SPECIFICATIONS ON  
THIS TEMPLATE.

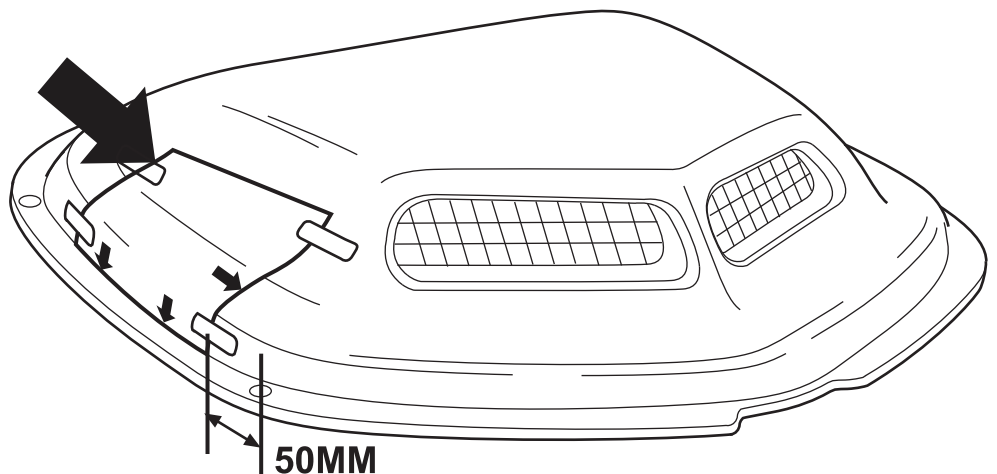

EDGE OF TEMPLATE SHOULD BE 50mm FROM CENTER OF  
FRONT HOOD SCOOP MOUNTING HOLE. MAKE A MARK WITH  
GREASE PENCIL AND TAPE TEMPLATE IN PLACE.

